



## BALANCE™ KNEE OFM1

Mechanical polycentric knee joint  
with 2-in-1 function

### USER PROFILE:

- Transfemoral or knee disarticulation amputation
- K-Levels 1 and 2
- Maximum user weight 300 lb / 136 kg

### KEY FEATURES:

- Optional adjustable stance flexion
- Integrated rotation and shift adjustment
- Can be used as a locked knee or free knee
- Integrated extension spring
- Adjustable swing phase resistance
- Large knee flexion range 0° to 150°
- Ideal knee for rehabilitation

# BALANCE™ KNEE OFM1

## KEY FEATURES



2-in-1 function



Adjustable swing phase



Adjustable axle friction



Polycentric joint construction

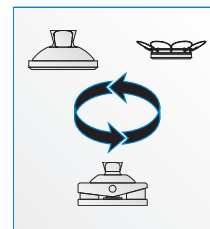

Socket connector options

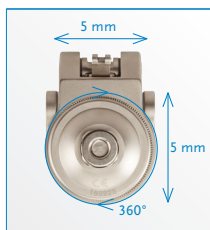

5mm A/P M/L shift  
360° rotation



Large 150° flexion range



Knee protection cap



Optional adjustable stance flexion

## TECHNICAL INFORMATION

|                             | Balance Knee OFM1<br>with IKF adapter              | Balance Knee OFM1<br>with loop adapter | Balance Knee OFM1<br>with pyramid |
|-----------------------------|--|--|-----------------------------------|
| Material                    | Aluminium  | Aluminium                              | Aluminium                         |
| Amputation level            | Transfemoral                                       | Knee disarticulation, transfemoral     | Transfemoral                      |
| Overall fitted height (1)   | Approx. 159 mm                                     | Approx. 151 mm                         | Approx. 174 mm                    |
| Effective fitted height (2) | Approx. 107 mm                                     | Approx. 116 mm                         | Approx. 122 mm                    |
| Fitted height (3)           | Approx. 18 mm                                      | Approx. 27 mm                          | Approx. 33 mm                     |
| Weight                      | Approx. 640 g                                      | Approx. 650 g                          | Approx. 770 g                     |
| Ground Clearance            | Approx. 13 mm                                      | Approx. 13 mm                          | Approx. 13 mm                     |
| Proximal connection         | Pyramid  | Loop adapter                           | Pyramid                           |
| Distal connection           | 30 mm tube clamp                                   | 30 mm tube clamp                       | 30 mm tube clamp                  |
| Swing phase                 | Integrated extension spring                        | Integrated extension spring            | Integrated extension spring       |
| Stance phase                | Adjustable stability and adjustable stance flexion | Adjustable stability                   | Adjustable stability              |
| Axis                        | Polycentric  | Polycentric                            | Polycentric                       |
| Flexion range               | 0–150°   | 0–150°                                 | 0–150°                            |

**SUGGESTED BILLING CODES\***  
L5611, L5845, L5850, L5925

**SUGGESTED BILLING CODES\***  
L5611, L5850, L5925

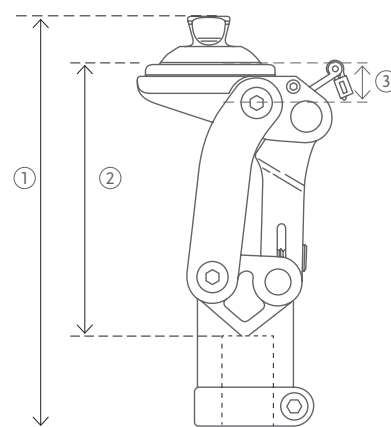

## PRODUCT INFORMATION

| Part#     | Description                         |
|-----------|-------------------------------------|
| 1 721 126 | Balance Knee OFM1 with pyramid      |
| 1 721 127 | Balance Knee OFM1 with IKF adapter  |
| 1 721 128 | Balance Knee OFM1 with loop adapter |

\* The responsibility for accurate coding lies solely with the provider treating the patient. Össur assumes no responsibility or liability for the provider's coding decisions. Össur's coding suggestions rest on its best judgment and are subject to revision.

FOLLOW ÖSSUR ON



TEL (800) 233-6263  
CANADA (800) 663-5982  
WWW.OSSUR.COM

